

Discover the **art**
of the **perfect** meeting



Anantara

BANGKOK • SATHORN



Sawadee

Welcome

to inspirational meetings and events

Edging the business district in the heart of the capital, Anantara Bangkok Sathorn combines sophisticated design, impressive facilities and dramatic city views. Stylish accommodation, flavourful international dining experiences and rewarding lifestyle facilities make business a pleasure.

Stay on form in between meetings with our well equipped fitness centre and outdoor pool area. Catch up on emails wherever the mood takes you with complimentary WiFi in the hotel lobby. Discover exclusive privileges at Kasara Lounge. Meet with colleagues in the chic Zin Bar lobby lounge, and return at night to wind down with a soothing cocktail. Acknowledge success with 360 degree cityscape view at ZOOM Sky Bar & Restaurant, a chicly designed rooftop bar. Indulge in an extensive variety of French, Mediterranean and Asian bar snacks, plus a diverse beverage menu.

Balance meetings and events with vibrant exploration of everything that Bangkok has to offer. Take the hotel's complimentary shuttle van and tuk tuk to the nearby Skytrain (BTS) station for easy access to prime business, shopping, dining, entertainment and cultural hubs.



Comprehensive Conference Facilities

Creating the ultimate meeting or event is a work of art that draws on Anantara's flawless hallmarks. Let our experienced team of expert professionals perfect the occasion with imaginative ideas and exquisite attention to detail, with a professional approach matched by heartfelt hospitality and personalised service.

Benefit from a choice of impressive venues, fine banqueting options, a 24 hour business centre and secretarial services, including audiovisual and video-conferencing facilities, photocopying and translating.

Flexible Meeting Rooms

Sathorn I (276 square metres)

Host a dinner and dance for 180 people and a reception for 300, or choose from a range of flexible seating options for large conferences.

Sathorn II (47 square metres)

Create a 40 guest reception, 30 person banquet, or theatre style meeting for 36 delegates.

Sathorn III (44 square metres)

This intimate venue is ideal for a 38 guest reception or meeting for 32 executives.

Skylight Room (212 square metres)

Prestigiously located on the 38th floor to boast the loftiest 180 degree panorama our hotel has to offer, the Skylight Room is the perfect venue for a reception of up to 100 people.







Skylight Suites (46 to 82 square metres)

A collection of three intimate venues on the 38th floor afford staggering city views, and can be used as an executive boardroom or tea break space.





A host of Conference Facilities

Meeting rooms								
			Theatre	Classroom	U-Shape	Boardroom	Banquet	Cocktail
	Area	Dimension (WxL)						
	Metres ²	Metres						
Sathorn I	276	11.5 x 24	238	150	30	60	180	300
Sathorn II	47	6.9 x 6.8	36	12	15	17	30	40
Sathorn III	44	6.5 x 6.8	32	12	15	17	20	38
Pre Function	332	7.8 x 42.8	-	-	-	-	-	150
Skylight Room	212	20 x 10.6	80	60	25	30	80	100
Skylight Suite I	46	5.5 x 8.3	20	10	12	12	20	25
Skylight Suite II	53	6 x 8.9	-	-	-	-	8	15
Skylight Suite III	82	5.1 x 16	50	28	25	25	30	45

Floor Plans

Mezzanine Floor

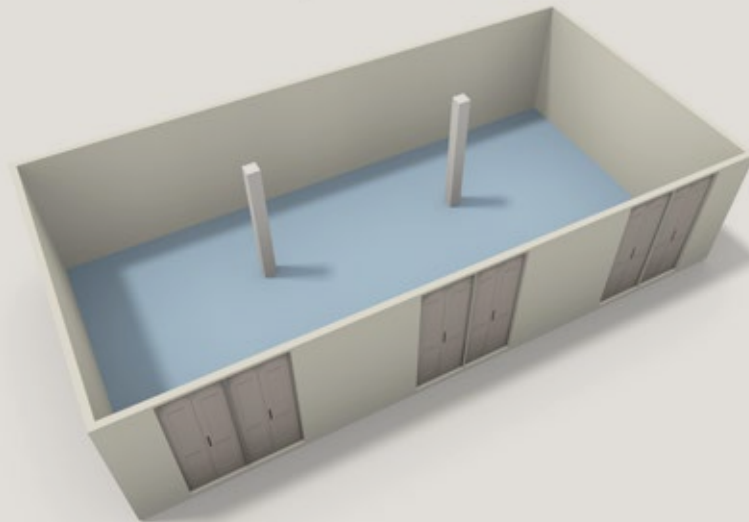
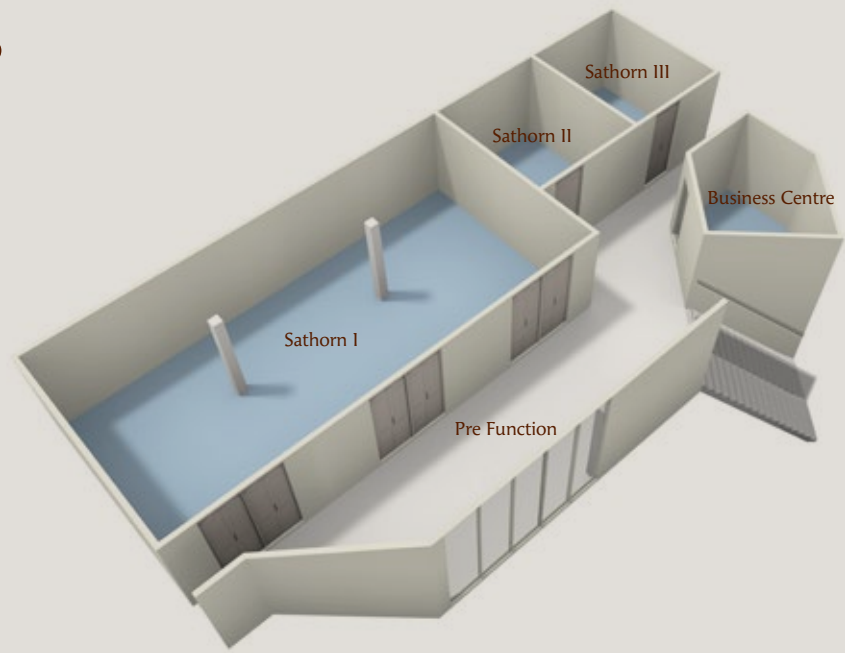

Sathorn I

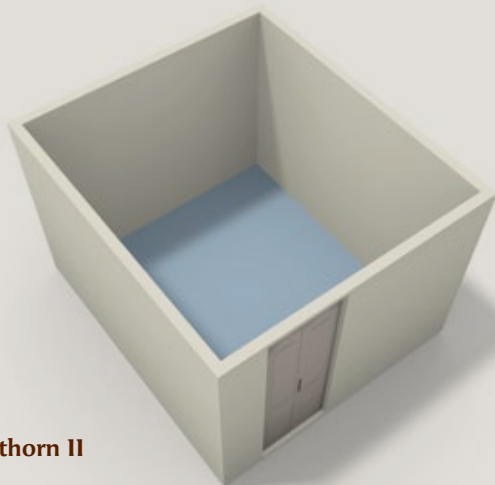

Sathorn II

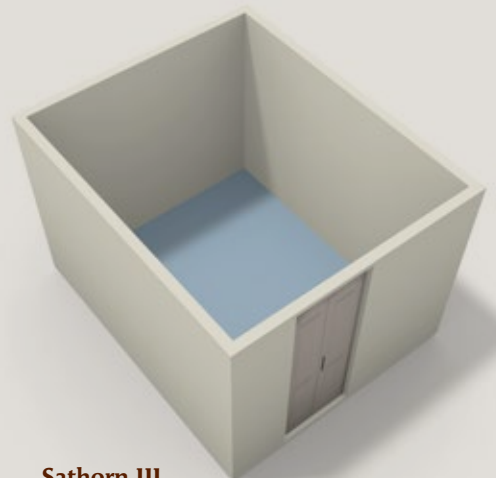

Sathorn III

38th Floor

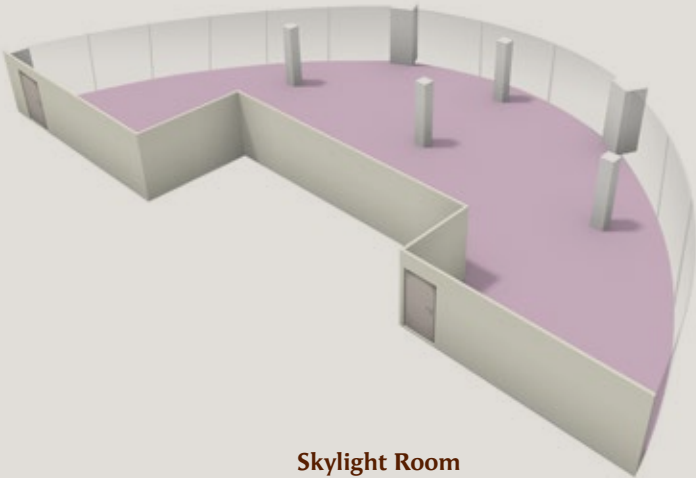

Skylight Room

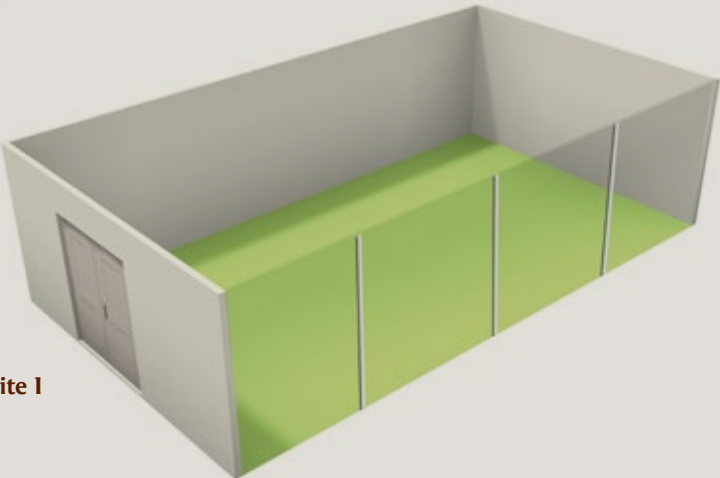

Skylight Suite I

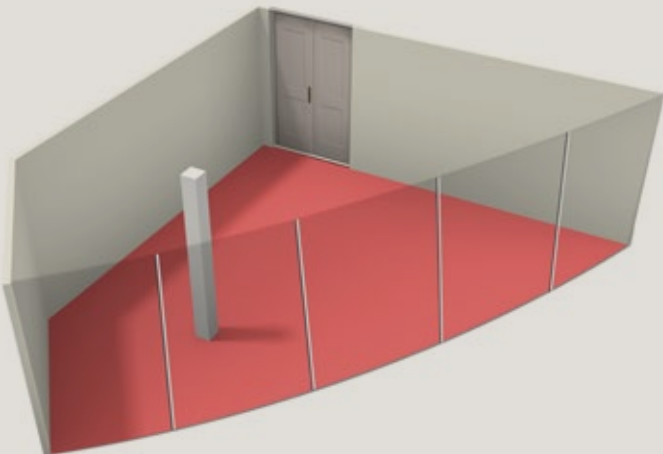

Skylight Suite II

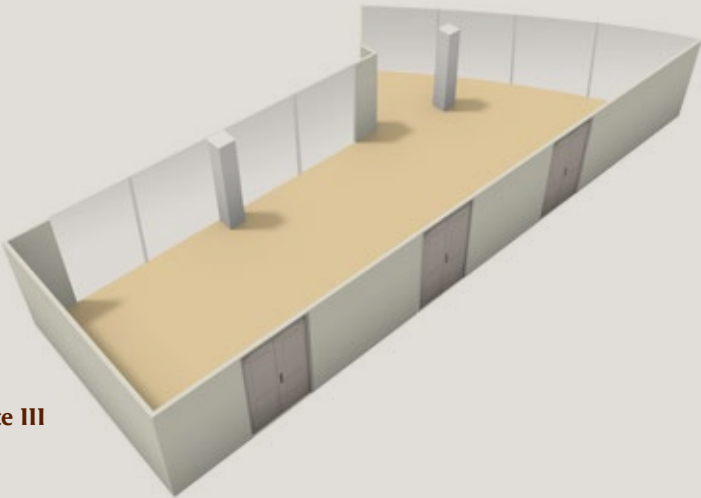

Skylight Suite III

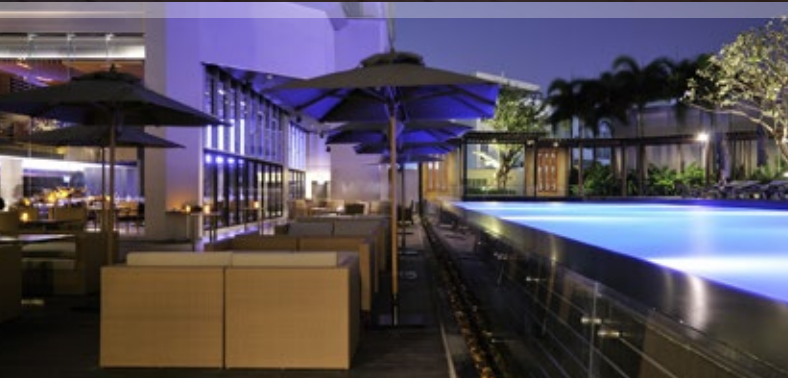

Impressive Hotel Facilities

A choice of rooms and suites offer contemporary designer style and a wealth of modern comforts, with a private balcony and floor to ceiling windows revealing expansive city views.

Energise before a meeting or de-stress afterwards at our well equipped fitness centre, open 24 hours a day. Challenge a colleague to a tennis match, or take the opportunity to practice your swing at one of Bangkok's golf courses and driving ranges. An impressive 32 metre infinity pool, Jacuzzi and sundeck invite you to soak up a feeling of urban seclusion. Unique Asian therapies at Anantara Spa provide well deserved relaxation after an action packed day.

Discover Bangkok's diverse shopping attractions, bustling markets and iconic cultural sites. Experience the capital's colourful contrasts in river serenity, by traversing the canal maze by traditional longtail boat to see glittering temples and age old river life, or gliding past the Temple of Dawn and The Grand Palace with a cruise on the River of Kings.

- 310 rooms and suites
- 4 restaurants and bars
- Fitness centre
- Infinity edge swimming pool and Jacuzzi
- Anantara Spa
- Tennis court
- Children's club



Central City Location

Anantara Bangkok Sathorn is a 45 minute drive from both Suvarnabhumi and Don Muang international airports, made even more convenient by the hotel's limousine service.

Ideally situated on the edge of Bangkok's business district, close to Sathorn and Silom roads, as well as the Chao Phraya riverside, a wealth of business hubs, shopping highlights, fine restaurants and vibrant nightlife options are all within easy reach. Hotel guests also benefit from multiple travel options so that they may explore the capital's cosmopolitan attractions with ease. Arkan Songkhro BRT bus station is a mere three minute walk, Chong Nonsi BTS is only seven, and Lumpini subway MRT is only moments from the hotel. The hotel's complimentary shuttle van and tuk tuk connects to these public transport stations providing access to the entire city. While guests desiring scenic respite can visit Lumpini Park, located within close proximity to the hotel, and relax by the lake in the city's most popular green expanse.



Where **art** and business meet

Anantara Bangkok Sathorn

36 Narathiwat-Ratchanakarin Road, Yannawa, Sathorn, Bangkok 10120, Thailand

Tel: +66 2 210 9000 Fax: +66 2 210 9001

Email: bangkoksathorn@anantara.com

anantara.com

GDS Codes

Chain Code: GA
Galileo: 73905

Amadeus: BKK347
Sabre: 137020

Worldspan: 75347
Pegasus: ADBKKS

Plan your next masterpiece in Thailand • Cambodia • China • Indonesia •
Maldives • Mozambique • Qatar • United Arab Emirates • Vietnam



global hotel alliance

08/14